

Printed on JULY 24, 2025, by WAF

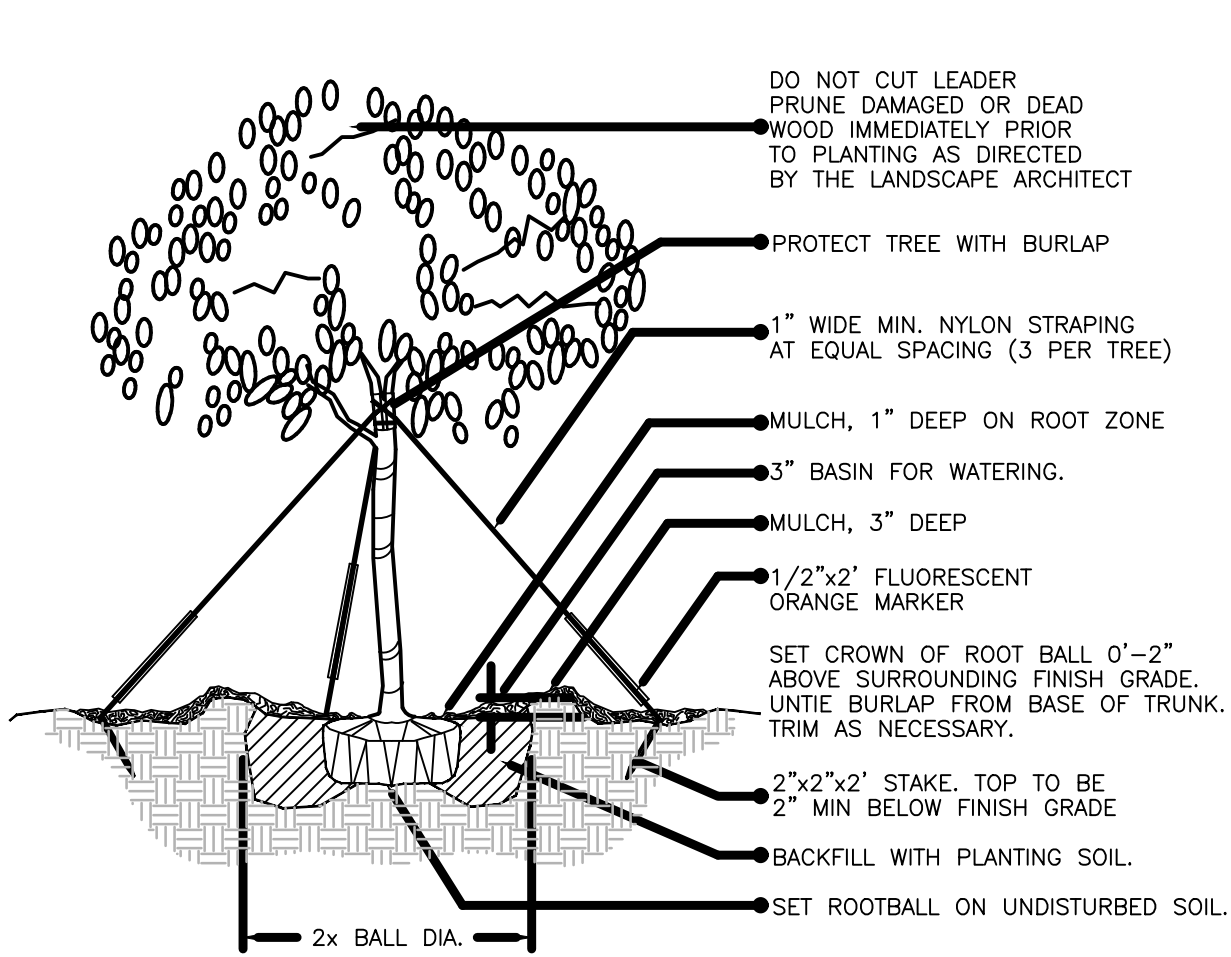

(2" cal. and over)  
LARGE TREE PLANTING DETAIL

NTS.

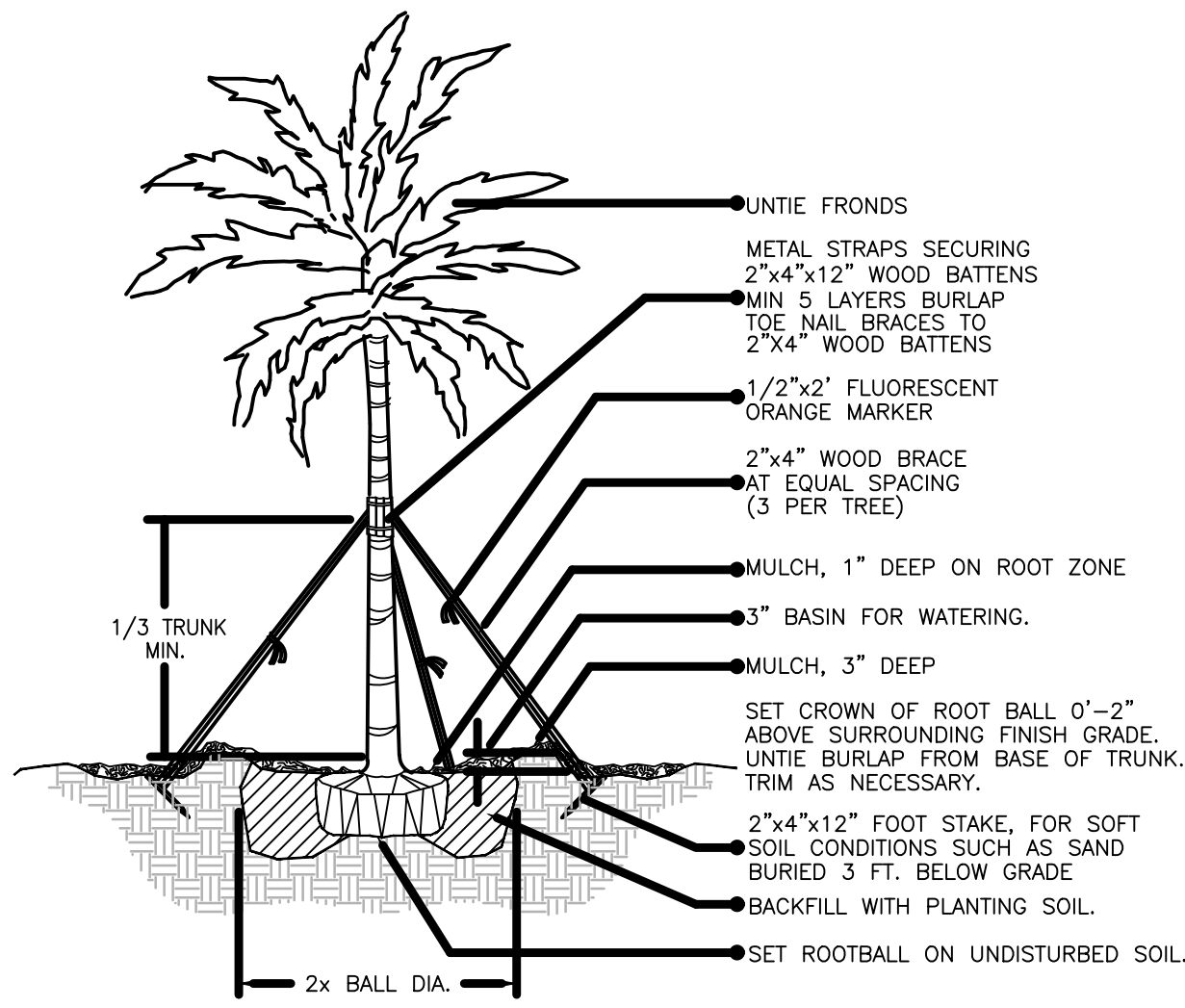

LARGE PALM PLANTING DETAIL

NTS.

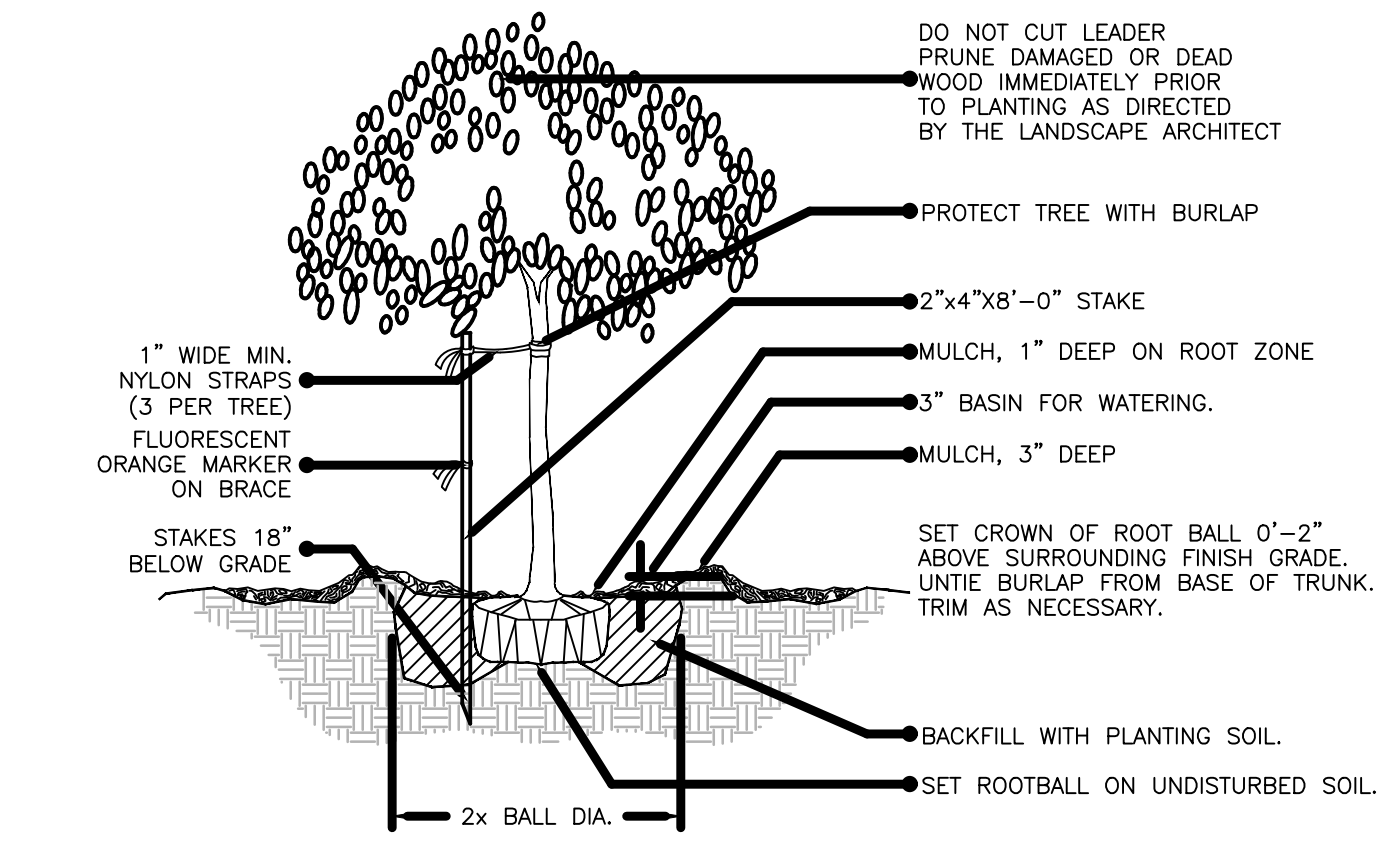

(2" cal. and under)  
SMALL TREE PLANTING DETAIL

NTS.

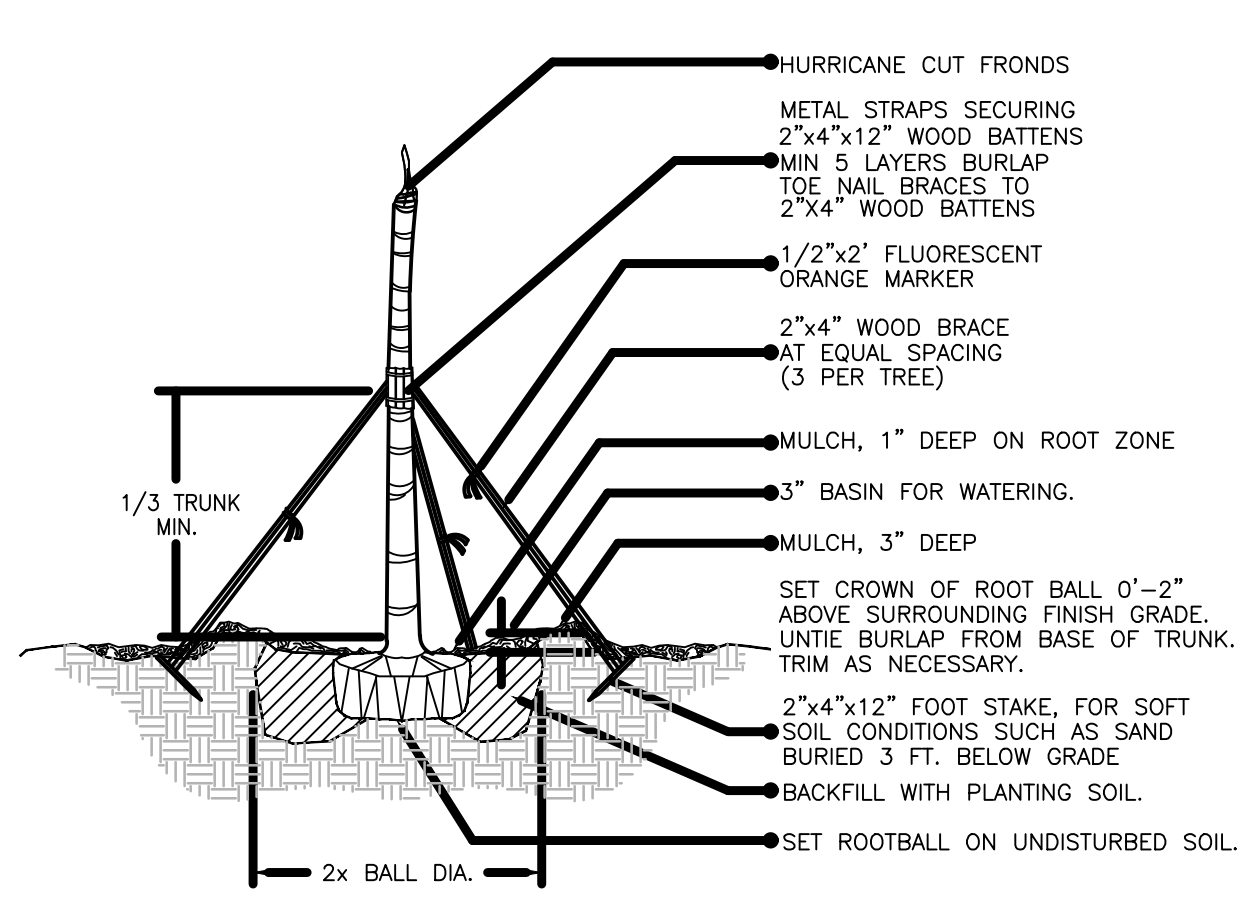

CIGARED SABAL  
PALM PLANTING DETAIL

NTS.

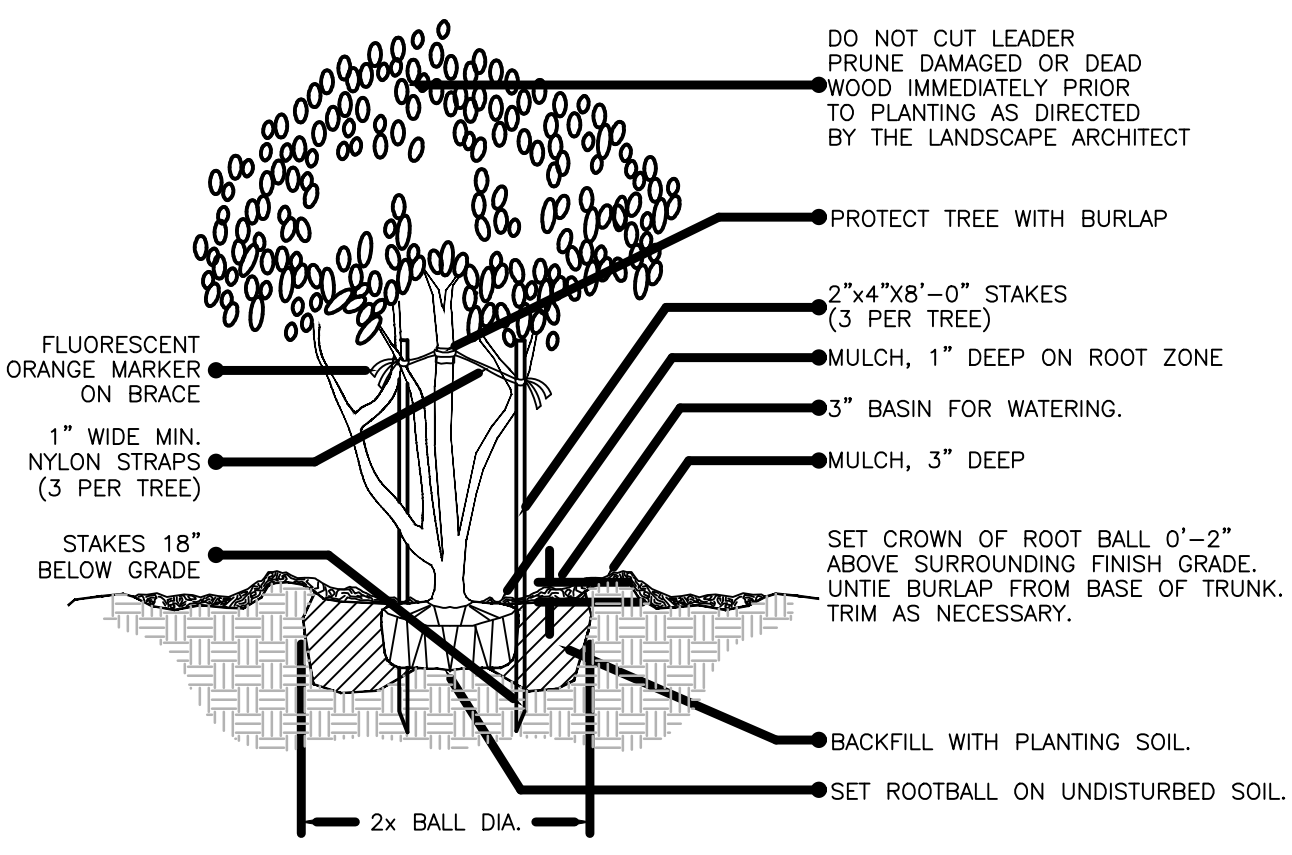

MULTI- TRUNK AND SMALL TREE  
(2" cal. and under) PLANTING DETAIL

NTS.

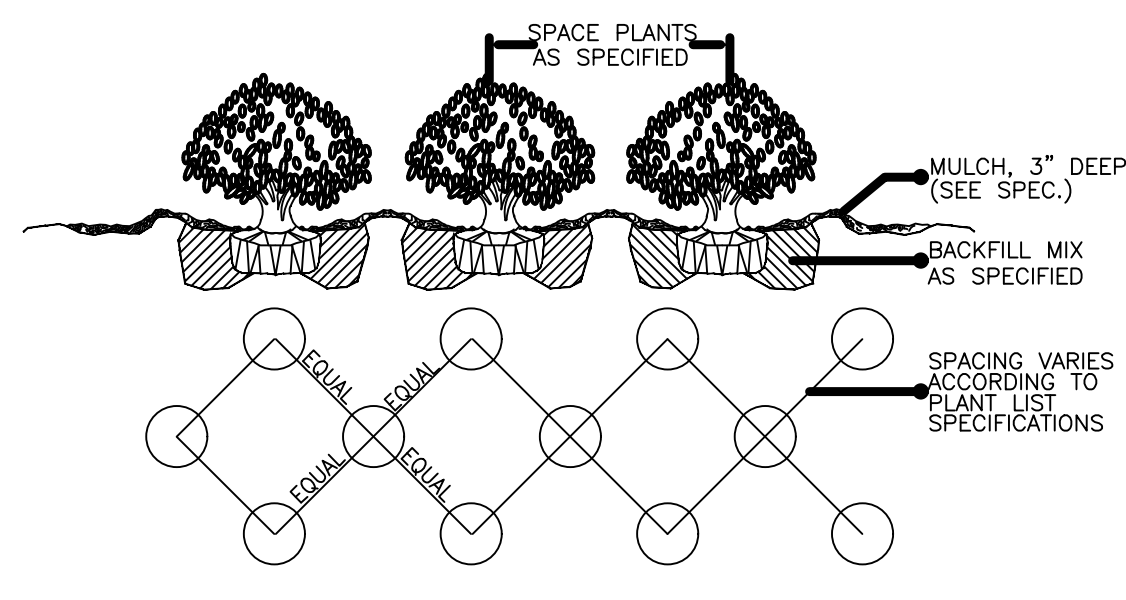

SHRUB / GROUNDCOVER  
SPACING / PLANTING DETAIL

NTS.

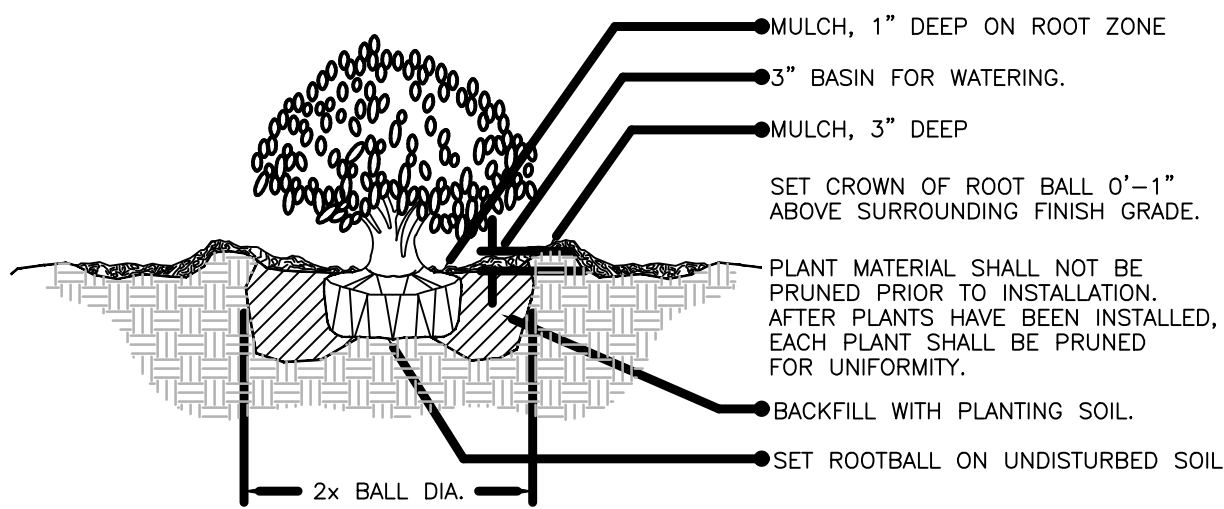

SHRUB PLANTING DETAIL

NTS.

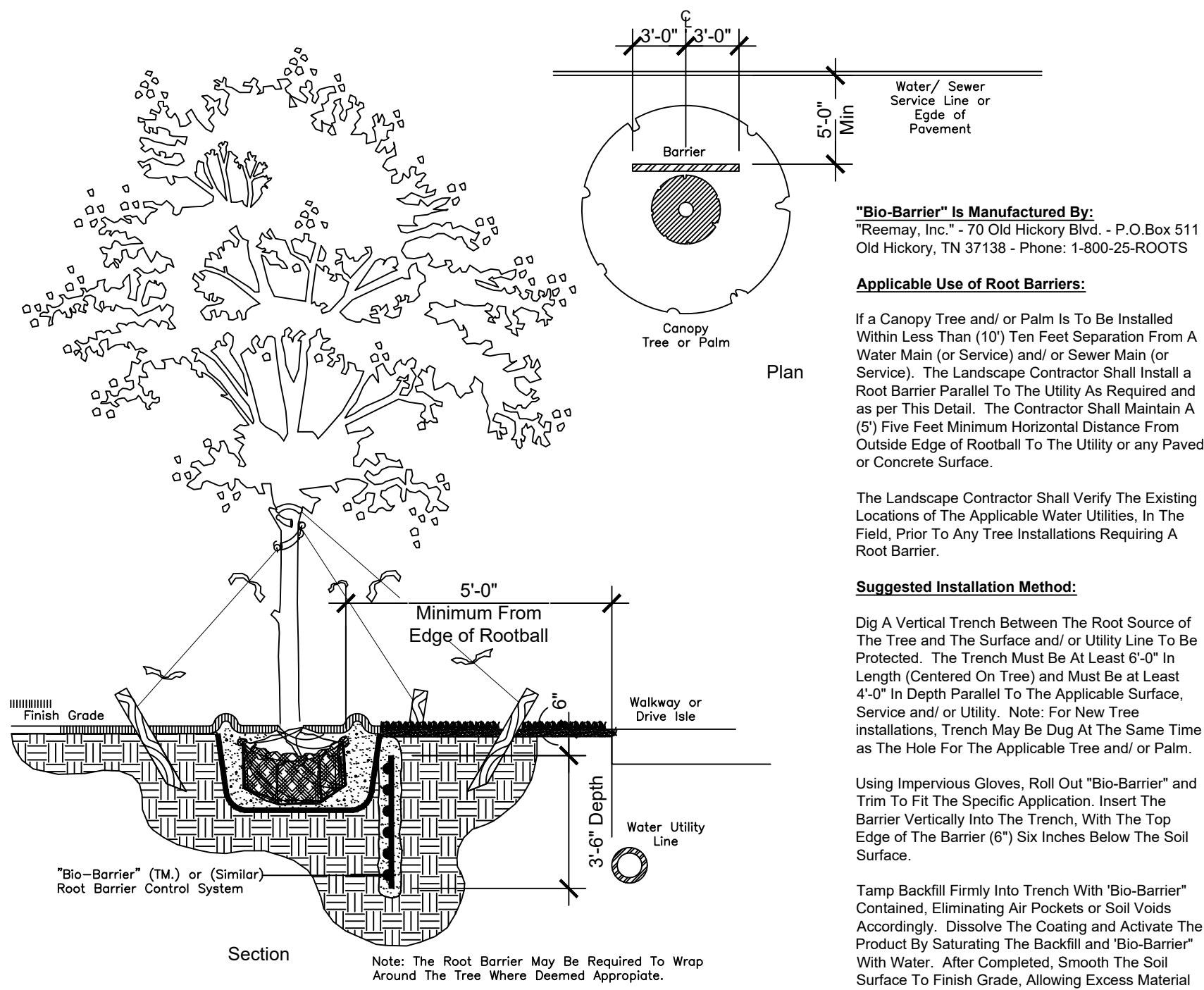

TYPICAL ROOT BARRIER APPLICATION DETAIL

